

LED TRACKLIGHT

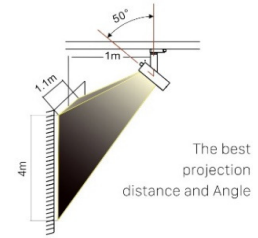

30K LIFE TIME HOURS or **50K** LIFE TIME HOURS
 IP20 INGRESS PROTECTION
 LM80 LED LM 80 **50K HRS**



Product Specification

Model No.	AvL-TRL-xxW-yyD-01-zK
Lumen (lm)	3690
Efficiency (lm/W)	82
Power (W)	45
Colour Temperature, CCT (K)	2700K, 3000K, 4000K, 5000K
Colour Index (CRI)	≥ 80
Beam Angle (°)	30°
Weight (Kg)	1.15, 1.41
Dimmable	No

General Specification

Input Voltage (VAC)	220 - 240
Power Factor (PF)	≥ 0.9
THD (%)	≤ 20
IP Rating	IP 20
Materials	Aluminium & Polycarbonate
Driver	External LED Driver (Within Casing)
Life Time (hours)	(A) 30000 (B,C) 50000
Warranty (years)	(A) 2 (B,C) 3
Finishing Color	White, Black, Silver
Operating Temp. (°C)	-20°C ~ 50°C
Working Humidity (% RH)	10 ~ 90
Storage Temp. (°C)	10°C - 65°C

Remark:

*x refers to W : 45W

*y refers to beam angle 30°

*z refers to CCT: 3-3000K, 4-4000K, 65-6500K

*Suggested mounting position : 1 meter from wall for a projection surface of 4 meter height

AdvanLED

Features

Applications



Home

Reference

AdvanLED



Malaysian Brand

MADE IN MALAYSIA

LED TRACKLIGHT

INDOOR

Photometric Result :

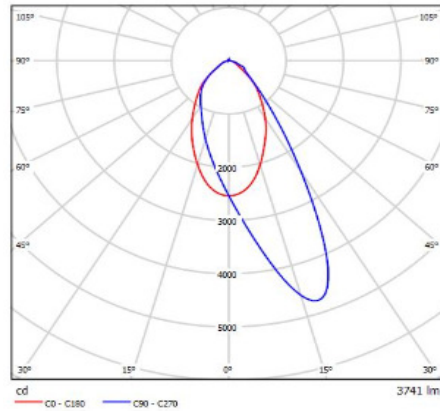

30°

Dimension (mm):

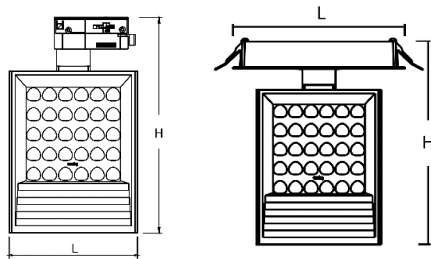

	type 1	type 2
Length (L)	228	224
Height (H)	129	177
Cut-out size	-	165

Installation Data / Driver Dimensions (mm)

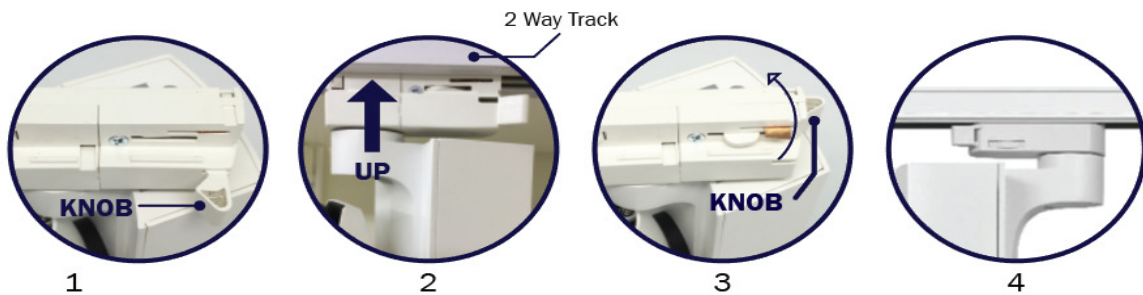

- *The above is a brief guide for track light installation
- *Standard 2 Way Track should be used
- *IMPORTANT: Electrical supply should be turned off before ant installation done