

LED SPOTLIGHT



AdvanLED



LIFE TIME

30K HOURS



INGRESS PROTECTION

IP20



LM80
50K HRS



LENS
MULTI-FOCUS

Product Specification

Model No.	AvL-TRL-xxW-ADJD-yK
Lumen (lm)	1600, 2400
Efficiency (lm/W)	80
Power (W)	20, 30
Colour Temperature, CCT (K)	2700K, 3000K, 4000K, 5000K
Colour Index (CRI)	≥ 80
Beam Angle (°)	20°~50°
Weight (Kg)	0.811
Dimmable	No

General Specification

Input Voltage (VAC)	220 - 240
Power Factor (PF)	≥ 0.9
THD (%)	≤ 20
IP Rating	IP 20
Materials	Aluminium & Polycarbonate
Driver	External LED Driver (Within Casing)
Life Time (hours)	30,000
Warranty (years)	2
Finishing Color	Black
Operating Temp. (°C)	-20°C ~ 50°C
Working Humidity (% RH)	10 ~ 90
Storage Temp. (°C)	10°C - 65°C

Features

- Adjustable beam

Applications



Home

Reference

Remark:

*x refers to W : 20W, 30W, 40W

*y refers to CCT: 3-3000K, 4-4000K, 65-6500K



AdvanLED

LED SPOTLIGHT

INDOOR

Photometric Result :

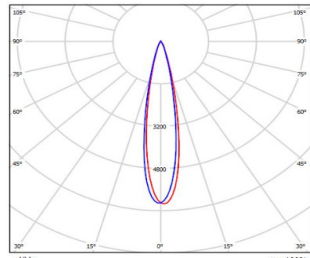

20°

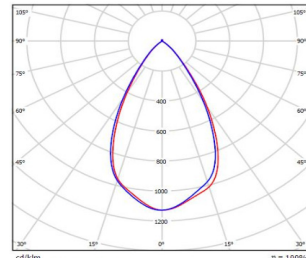

50°

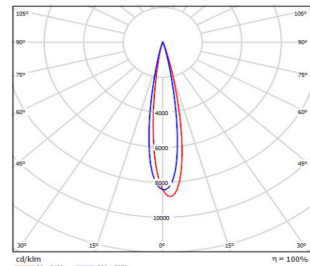

20°

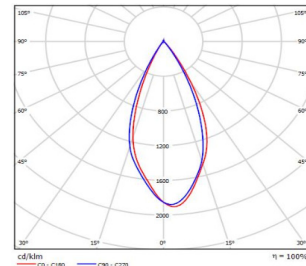

50°

Dimension (mm):

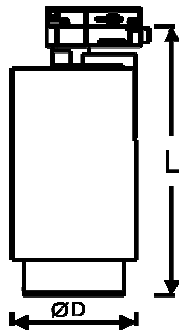

	20W	30W
Length (L1)	233, 236	233, 236
Diameter (D)	75	98

Installation Data / Driver Dimensions (mm)

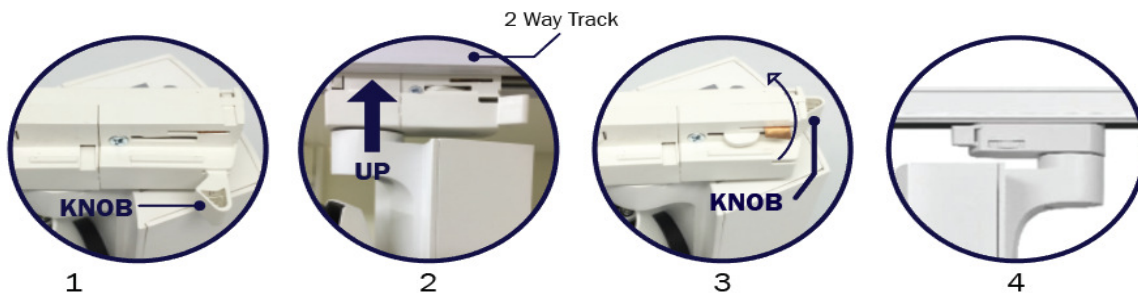

- *The above is a brief guide for track light installation
- *Standard 2 Way Track should be used
- *IMPORTANT: Electrical supply should be turned off before ant installation done